

1 - TUB  
 1 - 2 SECTION ALLEY  
 1 - SQUEEZE CHUTE

25 - 10' PANELS  
 8 - 10' WALKTHROUGHS  
 1 - W204-10 COMBO  
 3 - 3 WAY SPOOLS  
 6 - 3 WAY PINS  
 36 - FISH HOOKS  
 2 - A2 POSTS

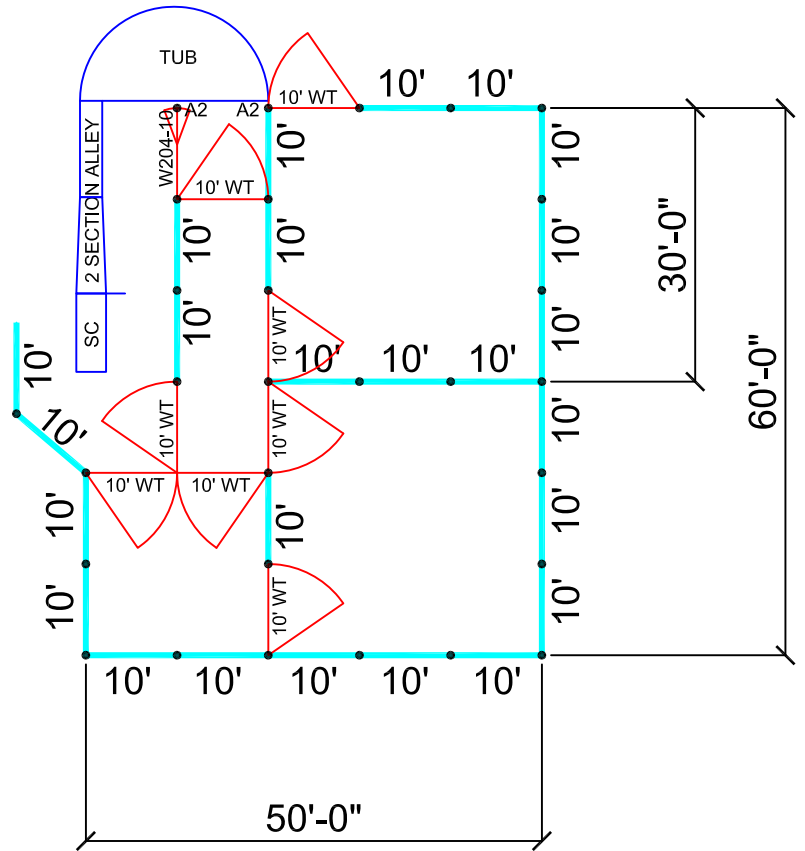

# 60' x 50' TUB AND ALLEY